

Planta de localização  
escala 1:50

Nome	Seção (cm)	X (cm)	Y (cm)	Pilar				Fundação						
				Carga Máx. (kN)	Carga Min. (kN)	Mx (kN.m)	My (kN.m)	Fx (kN)	Fy (kN)	Lado B (cm)	Lado H (cm)	h0 / ha (cm)	h1 / hb (cm)	df (cm)
P1	14x26	13.00	623.00	16	16	0	0	2	3	55	70	25	25	60
P2	14x26	622.50	617.00	21	20	0	0	3	2	55	70	25	25	60
P3	14x26	1017.00	623.00	14	14	0	2	1	3	65	55	20	30	60
P4	14x26	13.00	7.00	15	14	0	0	1	3	55	70	25	25	60
P5	14x26	358.00	7.00	11	11	0	0	2	1	55	70	25	25	60
P6	14x26	622.50	13.00	17	17	0	0	1	2	55	70	25	25	60
P7	14x26	1017.00	7.00	14	14	0	2	1	3	65	55	20	30	60

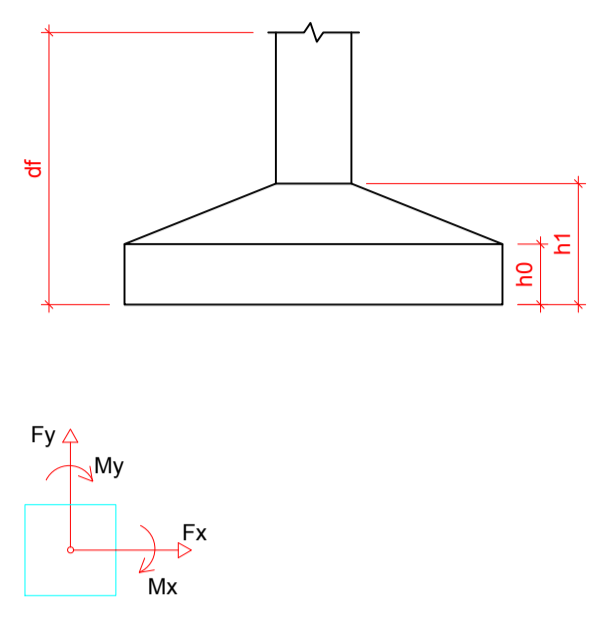

Localização no eixo X		Localização no eixo Y	
Coordenadas (cm)	Nome	Coordenadas (cm)	Nome
13.00	P1, P4	623.00	P1, P3
358.00	P5	617.00	P2
622.50	P2, P6	13.00	P6
1017.00	P3, P7	7.00	P4, P5, P7

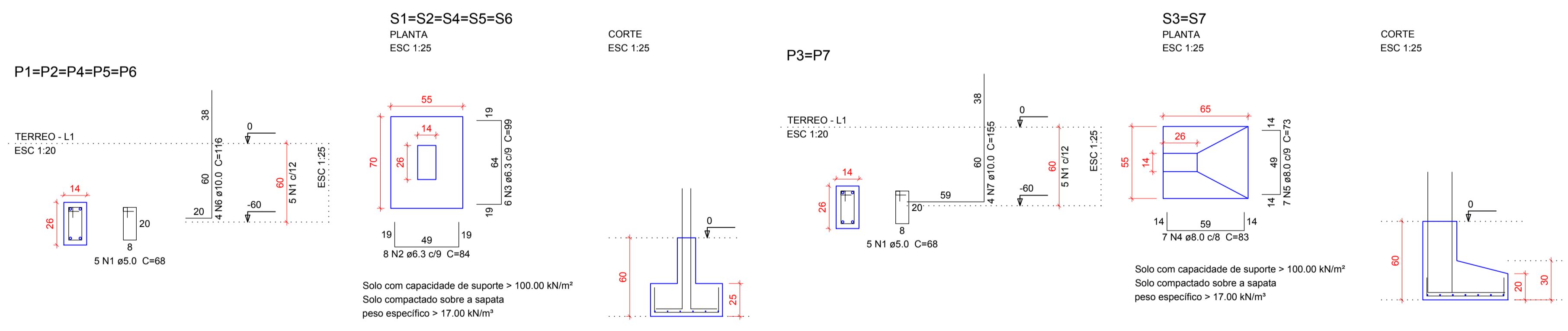

## Tabela de Resumos

SAPATAS		VIGAS BALDRAME (VB)		VIGAS DE RESPALDO (V)		PILARES																																																																																																																																																																																																																																														
<p>Relação do aço</p> <table border="1"> <thead> <tr> <th>5xS1</th> <th>2xS3</th> </tr> <tr> <th>AÇO</th> <th>N</th> <th>DIAM</th> <th>Q</th> <th>UNIT (cm)</th> <th>C.TOTAL (cm)</th> </tr> </thead> <tbody> <tr><td>CA60</td><td>1</td><td>5.0</td><td>35</td><td>68</td><td>2380</td></tr> <tr><td>CA50</td><td>2</td><td>6.3</td><td>40</td><td>84</td><td>3360</td></tr> <tr><td></td><td>3</td><td>6.3</td><td>30</td><td>99</td><td>2970</td></tr> <tr><td></td><td>4</td><td>8.0</td><td>14</td><td>83</td><td>1162</td></tr> <tr><td></td><td>5</td><td>8.0</td><td>14</td><td>73</td><td>1022</td></tr> <tr><td></td><td>6</td><td>10.0</td><td>20</td><td>116</td><td>2320</td></tr> <tr><td></td><td>7</td><td>10.0</td><td>8</td><td>155</td><td>1240</td></tr> </tbody> </table> <p>Resumo do aço</p> <table border="1"> <thead> <tr> <th>AÇO</th> <th>DIAM (m)</th> <th>C.TOTAL (m)</th> <th>PESO (kg)</th> </tr> </thead> <tbody> <tr><td>CA50</td><td>6.3</td><td>63.3</td><td>15.5</td></tr> <tr><td></td><td>8.0</td><td>21.9</td><td>8.6</td></tr> <tr><td></td><td>10.0</td><td>35.6</td><td>21.9</td></tr> <tr><td>CA60</td><td>5.0</td><td>23.8</td><td>3.7</td></tr> </tbody> </table> <p>PESO TOTAL</p> <table border="1"> <tbody> <tr><td>CA50</td><td>46.1</td></tr> <tr><td>CA60</td><td>3.7</td></tr> </tbody> </table> <p>Vol. de concreto total (C-25) = 0.81 m³</p>		5xS1	2xS3	AÇO	N	DIAM	Q	UNIT (cm)	C.TOTAL (cm)	CA60	1	5.0	35	68	2380	CA50	2	6.3	40	84	3360		3	6.3	30	99	2970		4	8.0	14	83	1162		5	8.0	14	73	1022		6	10.0	20	116	2320		7	10.0	8	155	1240	AÇO	DIAM (m)	C.TOTAL (m)	PESO (kg)	CA50	6.3	63.3	15.5		8.0	21.9	8.6		10.0	35.6	21.9	CA60	5.0	23.8	3.7	CA50	46.1	CA60	3.7	<p>Relação do aço</p> <table border="1"> <thead> <tr> <th>VB1 VB4</th> <th>VB2 VB5</th> <th>VB3</th> </tr> <tr> <th>AÇO</th> <th>N</th> <th>DIAM</th> <th>Q</th> <th>UNIT (cm)</th> <th>C.TOTAL (cm)</th> </tr> </thead> <tbody> <tr><td>CA60</td><td>1</td><td>5.0</td><td>250</td><td>76</td><td>19000</td></tr> <tr><td>CA50</td><td>2</td><td>6.3</td><td>4</td><td>1024</td><td>4096</td></tr> <tr><td></td><td>3</td><td>6.3</td><td>4</td><td>1041</td><td>4164</td></tr> <tr><td></td><td>4</td><td>6.3</td><td>6</td><td>624</td><td>3744</td></tr> <tr><td></td><td>5</td><td>6.3</td><td>4</td><td>669</td><td>2676</td></tr> <tr><td></td><td>6</td><td>6.3</td><td>2</td><td>641</td><td>1282</td></tr> </tbody> </table> <p>Resumo do aço</p> <table border="1"> <thead> <tr> <th>AÇO</th> <th>DIAM (m)</th> <th>C.TOTAL (m)</th> <th>PESO (kg)</th> </tr> </thead> <tbody> <tr><td>CA50</td><td>6.3</td><td>159.7</td><td>39.1</td></tr> <tr><td>CA60</td><td>5.0</td><td>190</td><td>29.3</td></tr> </tbody> </table> <p>PESO TOTAL</p> <table border="1"> <tbody> <tr><td>CA50</td><td>39.1</td></tr> <tr><td>CA60</td><td>29.3</td></tr> </tbody> </table> <p>Vol. de concreto total (C-25) = 1.66 m³ Área de forma total = 23.16 m²</p>		VB1 VB4	VB2 VB5	VB3	AÇO	N	DIAM	Q	UNIT (cm)	C.TOTAL (cm)	CA60	1	5.0	250	76	19000	CA50	2	6.3	4	1024	4096		3	6.3	4	1041	4164		4	6.3	6	624	3744		5	6.3	4	669	2676		6	6.3	2	641	1282	AÇO	DIAM (m)	C.TOTAL (m)	PESO (kg)	CA50	6.3	159.7	39.1	CA60	5.0	190	29.3	CA50	39.1	CA60	29.3	<p>Relação do aço</p> <table border="1"> <thead> <tr> <th>V1 V4</th> <th>V2 V5</th> <th>V3 VP1</th> </tr> <tr> <th>AÇO</th> <th>N</th> <th>DIAM</th> <th>Q</th> <th>UNIT (cm)</th> <th>C.TOTAL (cm)</th> </tr> </thead> <tbody> <tr><td>CA60</td><td>1</td><td>5.0</td><td>250</td><td>76</td><td>19000</td></tr> <tr><td></td><td>2</td><td>5.0</td><td>27</td><td>66</td><td>1782</td></tr> <tr><td>CA50</td><td>3</td><td>6.3</td><td>4</td><td>1024</td><td>4096</td></tr> <tr><td></td><td>4</td><td>6.3</td><td>4</td><td>1069</td><td>4276</td></tr> <tr><td></td><td>5</td><td>6.3</td><td>6</td><td>624</td><td>3744</td></tr> <tr><td></td><td>6</td><td>6.3</td><td>6</td><td>669</td><td>4014</td></tr> <tr><td></td><td>7</td><td>6.3</td><td>4</td><td>365</td><td>1460</td></tr> </tbody> </table> <p>Resumo do aço</p> <table border="1"> <thead> <tr> <th>AÇO</th> <th>DIAM (m)</th> <th>C.TOTAL (m)</th> <th>PESO (kg)</th> </tr> </thead> <tbody> <tr><td>CA50</td><td>6.3</td><td>175.9</td><td>43</td></tr> <tr><td>CA60</td><td>5.0</td><td>207.9</td><td>32</td></tr> </tbody> </table> <p>PESO TOTAL</p> <table border="1"> <tbody> <tr><td>CA50</td><td>43</td></tr> <tr><td>CA60</td><td>32</td></tr> </tbody> </table> <p>Vol. de concreto total (C-25) = 1.79 m³ Área de forma total = 31.6 m²</p>		V1 V4	V2 V5	V3 VP1	AÇO	N	DIAM	Q	UNIT (cm)	C.TOTAL (cm)	CA60	1	5.0	250	76	19000		2	5.0	27	66	1782	CA50	3	6.3	4	1024	4096		4	6.3	4	1069	4276		5	6.3	6	624	3744		6	6.3	6	669	4014		7	6.3	4	365	1460	AÇO	DIAM (m)	C.TOTAL (m)	PESO (kg)	CA50	6.3	175.9	43	CA60	5.0	207.9	32	CA50	43	CA60	32	<p>Relação do aço</p> <table border="1"> <thead> <tr> <th>7xP1</th> </tr> <tr> <th>AÇO</th> <th>N</th> <th>DIAM</th> <th>Q</th> <th>UNIT (cm)</th> <th>C.TOTAL (cm)</th> </tr> </thead> <tbody> <tr><td>CA60</td><td>1</td><td>5.0</td><td>175</td><td>68</td><td>11900</td></tr> <tr><td>CA50</td><td>2</td><td>10.0</td><td>28</td><td>297</td><td>8316</td></tr> </tbody> </table> <p>Resumo do aço</p> <table border="1"> <thead> <tr> <th>AÇO</th> <th>DIAM (m)</th> <th>C.TOTAL (m)</th> <th>PESO (kg)</th> </tr> </thead> <tbody> <tr><td>CA50</td><td>10.0</td><td>83.2</td><td>51.3</td></tr> <tr><td>CA60</td><td>5.0</td><td>119</td><td>18.3</td></tr> </tbody> </table> <p>PESO TOTAL</p> <table border="1"> <tbody> <tr><td>CA50</td><td>51.3</td></tr> <tr><td>CA60</td><td>18.3</td></tr> </tbody> </table> <p>Vol. de concreto total (C-25) = 0.76 m³ Área de forma total = 16.8 m²</p>		7xP1	AÇO	N	DIAM	Q	UNIT (cm)	C.TOTAL (cm)	CA60	1	5.0	175	68	11900	CA50	2	10.0	28	297	8316	AÇO	DIAM (m)	C.TOTAL (m)	PESO (kg)	CA50	10.0	83.2	51.3	CA60	5.0	119	18.3	CA50	51.3	CA60	18.3
5xS1	2xS3																																																																																																																																																																																																																																																			
AÇO	N	DIAM	Q	UNIT (cm)	C.TOTAL (cm)																																																																																																																																																																																																																																															
CA60	1	5.0	35	68	2380																																																																																																																																																																																																																																															
CA50	2	6.3	40	84	3360																																																																																																																																																																																																																																															
	3	6.3	30	99	2970																																																																																																																																																																																																																																															
	4	8.0	14	83	1162																																																																																																																																																																																																																																															
	5	8.0	14	73	1022																																																																																																																																																																																																																																															
	6	10.0	20	116	2320																																																																																																																																																																																																																																															
	7	10.0	8	155	1240																																																																																																																																																																																																																																															
AÇO	DIAM (m)	C.TOTAL (m)	PESO (kg)																																																																																																																																																																																																																																																	
CA50	6.3	63.3	15.5																																																																																																																																																																																																																																																	
	8.0	21.9	8.6																																																																																																																																																																																																																																																	
	10.0	35.6	21.9																																																																																																																																																																																																																																																	
CA60	5.0	23.8	3.7																																																																																																																																																																																																																																																	
CA50	46.1																																																																																																																																																																																																																																																			
CA60	3.7																																																																																																																																																																																																																																																			
VB1 VB4	VB2 VB5	VB3																																																																																																																																																																																																																																																		
AÇO	N	DIAM	Q	UNIT (cm)	C.TOTAL (cm)																																																																																																																																																																																																																																															
CA60	1	5.0	250	76	19000																																																																																																																																																																																																																																															
CA50	2	6.3	4	1024	4096																																																																																																																																																																																																																																															
	3	6.3	4	1041	4164																																																																																																																																																																																																																																															
	4	6.3	6	624	3744																																																																																																																																																																																																																																															
	5	6.3	4	669	2676																																																																																																																																																																																																																																															
	6	6.3	2	641	1282																																																																																																																																																																																																																																															
AÇO	DIAM (m)	C.TOTAL (m)	PESO (kg)																																																																																																																																																																																																																																																	
CA50	6.3	159.7	39.1																																																																																																																																																																																																																																																	
CA60	5.0	190	29.3																																																																																																																																																																																																																																																	
CA50	39.1																																																																																																																																																																																																																																																			
CA60	29.3																																																																																																																																																																																																																																																			
V1 V4	V2 V5	V3 VP1																																																																																																																																																																																																																																																		
AÇO	N	DIAM	Q	UNIT (cm)	C.TOTAL (cm)																																																																																																																																																																																																																																															
CA60	1	5.0	250	76	19000																																																																																																																																																																																																																																															
	2	5.0	27	66	1782																																																																																																																																																																																																																																															
CA50	3	6.3	4	1024	4096																																																																																																																																																																																																																																															
	4	6.3	4	1069	4276																																																																																																																																																																																																																																															
	5	6.3	6	624	3744																																																																																																																																																																																																																																															
	6	6.3	6	669	4014																																																																																																																																																																																																																																															
	7	6.3	4	365	1460																																																																																																																																																																																																																																															
AÇO	DIAM (m)	C.TOTAL (m)	PESO (kg)																																																																																																																																																																																																																																																	
CA50	6.3	175.9	43																																																																																																																																																																																																																																																	
CA60	5.0	207.9	32																																																																																																																																																																																																																																																	
CA50	43																																																																																																																																																																																																																																																			
CA60	32																																																																																																																																																																																																																																																			
7xP1																																																																																																																																																																																																																																																				
AÇO	N	DIAM	Q	UNIT (cm)	C.TOTAL (cm)																																																																																																																																																																																																																																															
CA60	1	5.0	175	68	11900																																																																																																																																																																																																																																															
CA50	2	10.0	28	297	8316																																																																																																																																																																																																																																															
AÇO	DIAM (m)	C.TOTAL (m)	PESO (kg)																																																																																																																																																																																																																																																	
CA50	10.0	83.2	51.3																																																																																																																																																																																																																																																	
CA60	5.0	119	18.3																																																																																																																																																																																																																																																	
CA50	51.3																																																																																																																																																																																																																																																			
CA60	18.3																																																																																																																																																																																																																																																			

APROVAÇÃO:



**CÂMARA MUNICIPAL DE NOVA GUARITA - MT**  
SITE: [www.novaguarita.mt.leg.br/](http://www.novaguarita.mt.leg.br/)  
e-mail: [camara.ngta@hotmail.com](mailto:camara.ngta@hotmail.com)

TIPO DE OBRA:	INSTITUCIONAL	MODALIDADE:	AMPLIAÇÃO
OBRA:	AMPLIAÇÃO DA CÂMARA DE VEREADORES DE NOVA GUARITA - MT		
PROPRIETÁRIO/ CNPJ:	CÂMARA MUNICIPAL DE NOVA GUARITA CNPJ: 01.909.326/0001-07		
ENDEREÇO:	AV. DOS MIGRANTES S/N, TRAVESSA "A", QUADRA RD-10, NOVA GUARITA/MT		
AUTOR DO PROJETO/ CREA:	CAIO VINICIUS OLIVEIRA MARQUES Engenheiro Civil CREA/MT: 041.258		
RESPONSÁVEL TÉCNICO P/ OBRA:			
<b>PROJETO DE ESTRUTURAS DE CONCRETO ARMADO</b>			
ASSUNTO: PLANTA DE LOCAÇÃO SAPATAS, TABELA DE RESUMO DE MATERIAIS			
LOCAL DO ARQUIVO:	QUADRO DE ÁREAS		
DATA DE ENTREGA: 23/06/2021	ÁREA AMPLIAR: 64,89 m²		
REVISÃO: 0-XX/XX/XXXX			
ESCALA: INDICADA			
ART:	DESENHO:		

**EST**

FOLHA Nº

**01**

02